

COMUNE DI OFFLAGA

Provincia di Brescia



PIANO DI GOVERNO DEL TERRITORIO

ai sensi della Legge Regionale 11 marzo 2005, n° 12

Modificato in base alle osservazioni accolte e al parere di compatibilità al PTCP

PIANO DELLE REGOLE VARIANTE GENERALE n.2

R.1.2b - Classificazione del territorio comunale: nuclei di antica formazione

Scala 1:1000

2020

Adottato con delibera del C.C. n°3
del 5/03/2020

Approvato con delibera del C.C. n°16
del 8/10/2020

Sindaco
dott. Giancarlo Mazza

Consigliere con delega all'urbanistica
dott. Lorenzo Sala

Responsabile Unico del Procedimento
geom. Romano Girelli

ESTENSORE
arch. Nicola Cantarelli



AEGIS
CANTARELLI + PARTNERS

COLLABORATORE
Ing. Elisa Brolli





LEGENDA



Confine Comunale



Nuclei di antica formazione

CATEGORIE TIPOLOGICHE DI INTERVENTO



A1



A2



A3*



A3



A4



A5



Piano di Recupero













24

23

25





41

78

8





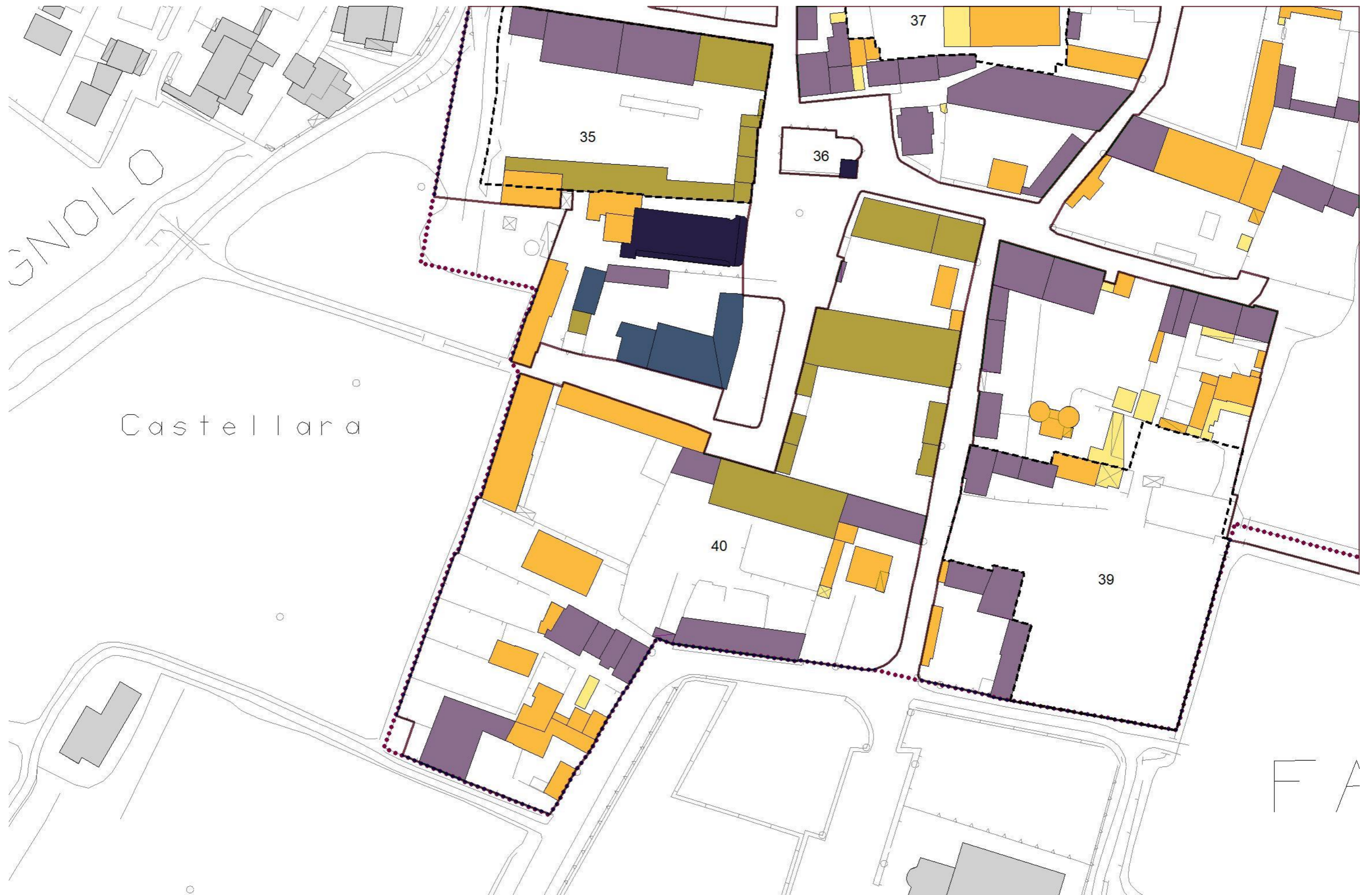

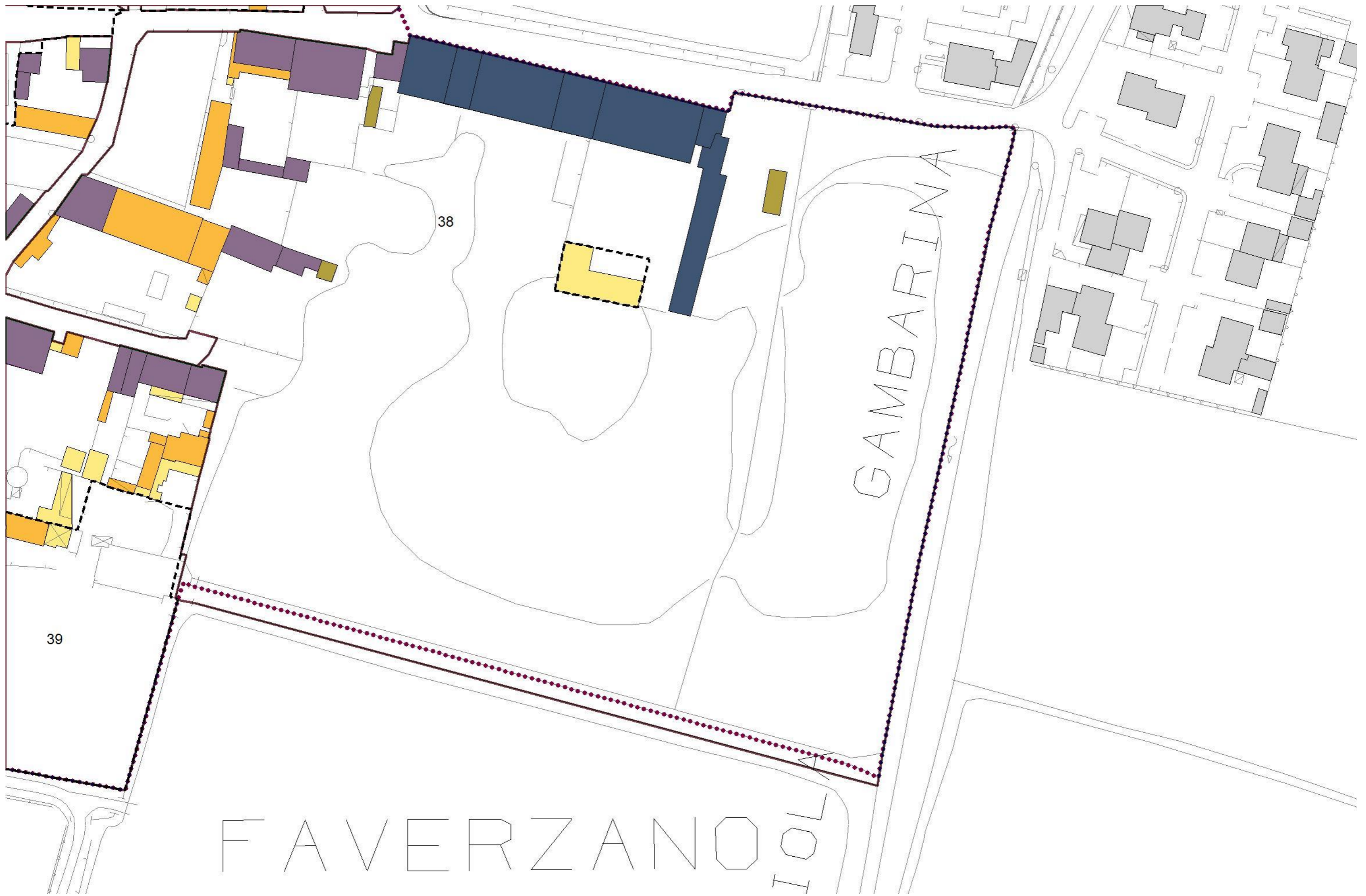

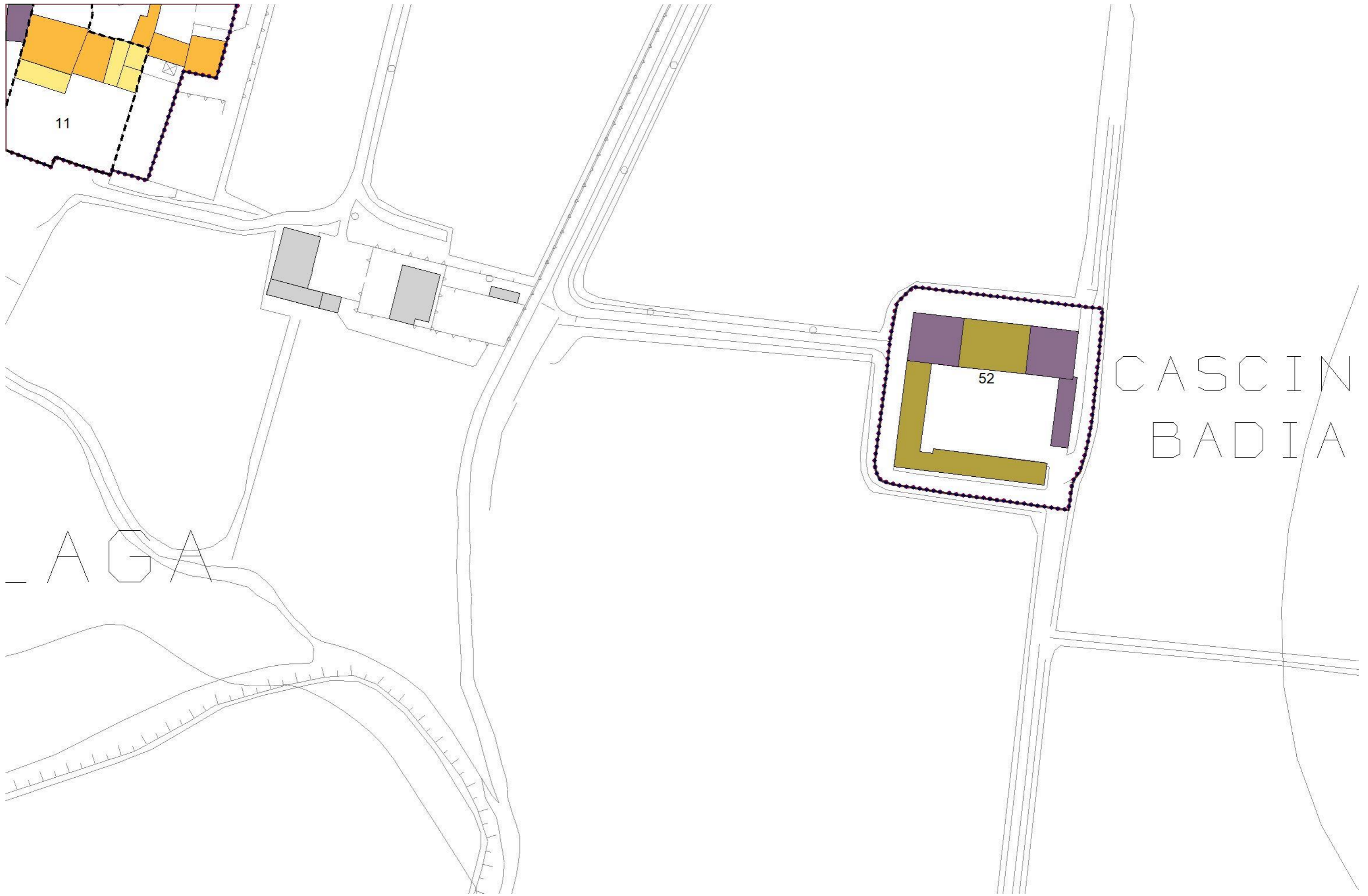

CASCINA
BADIA

LAGGA

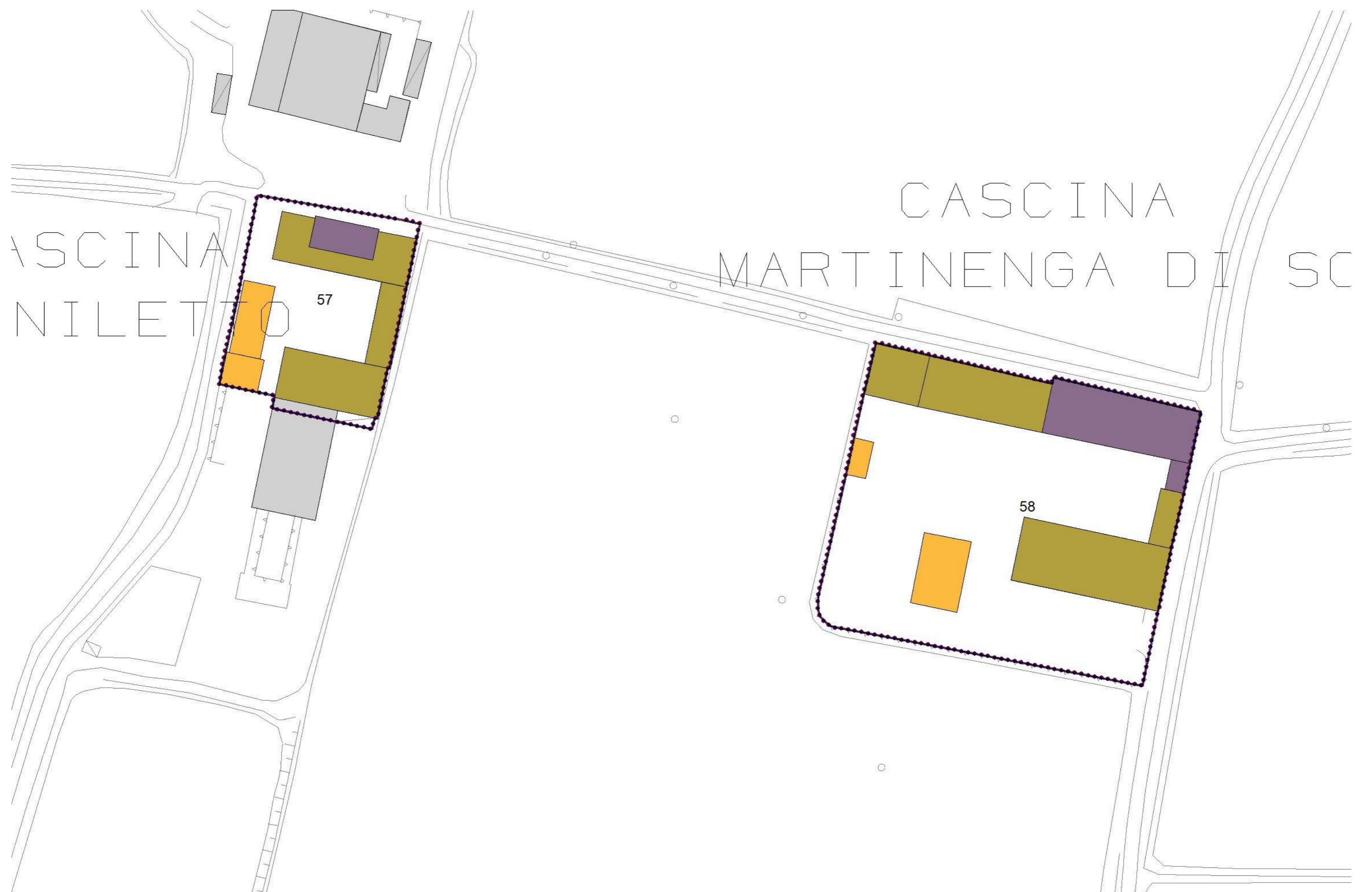

INA
GA DI SOTTO

MART

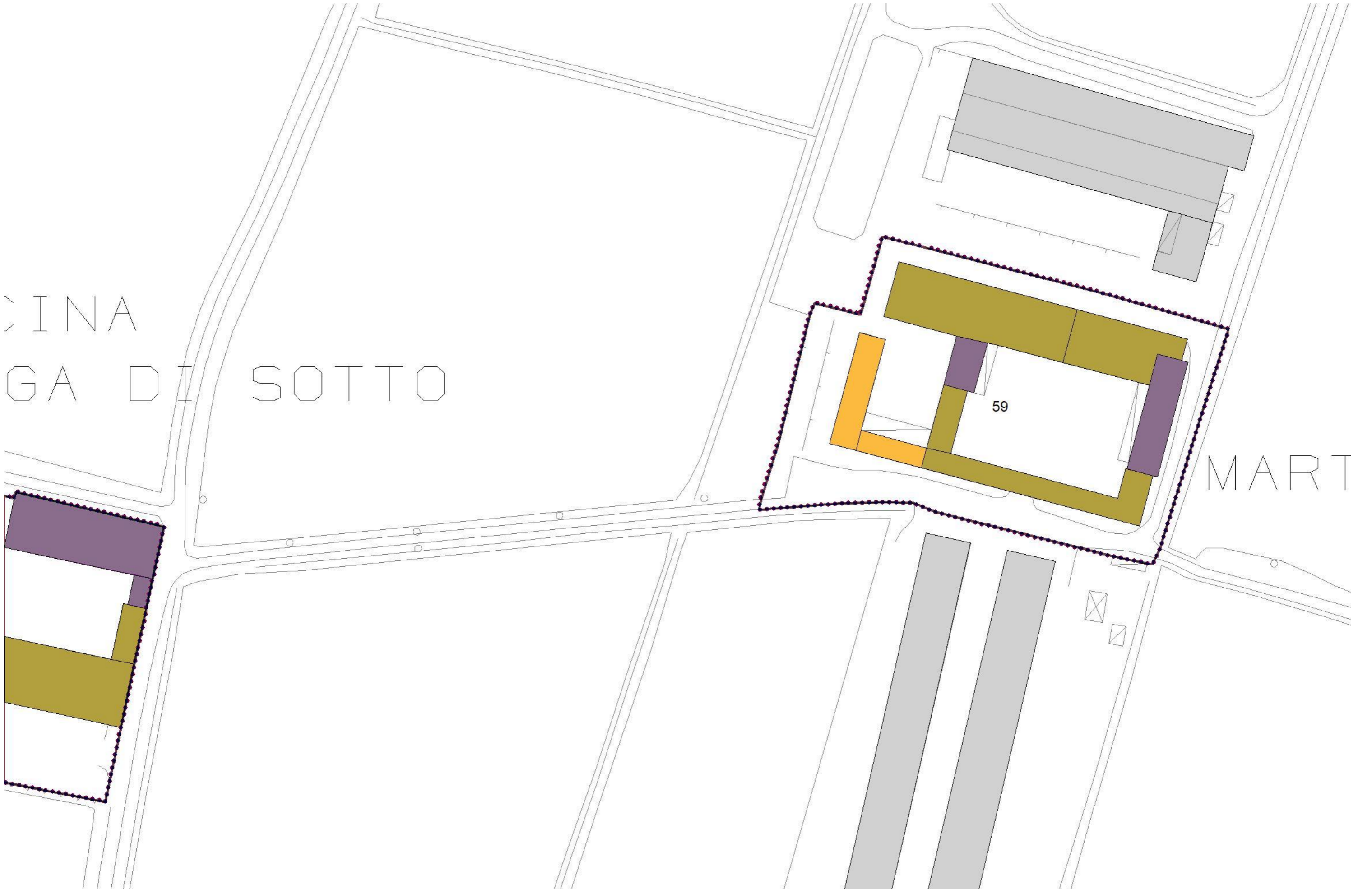

CASCINA
INENGA DI SOPRA

SAN

FAUSTINO

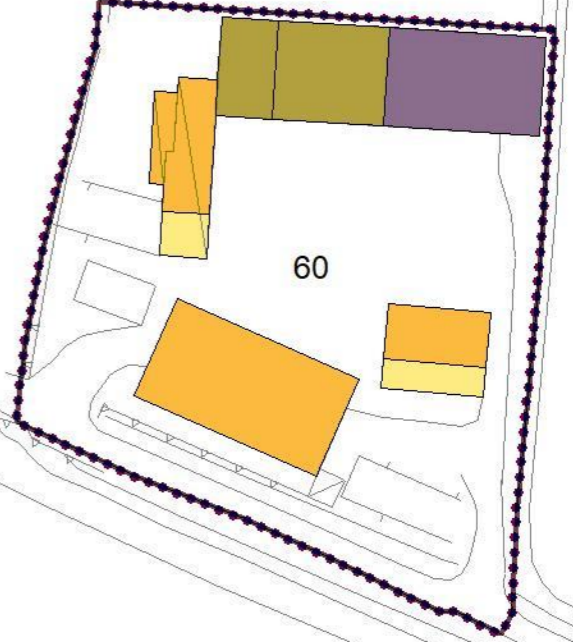





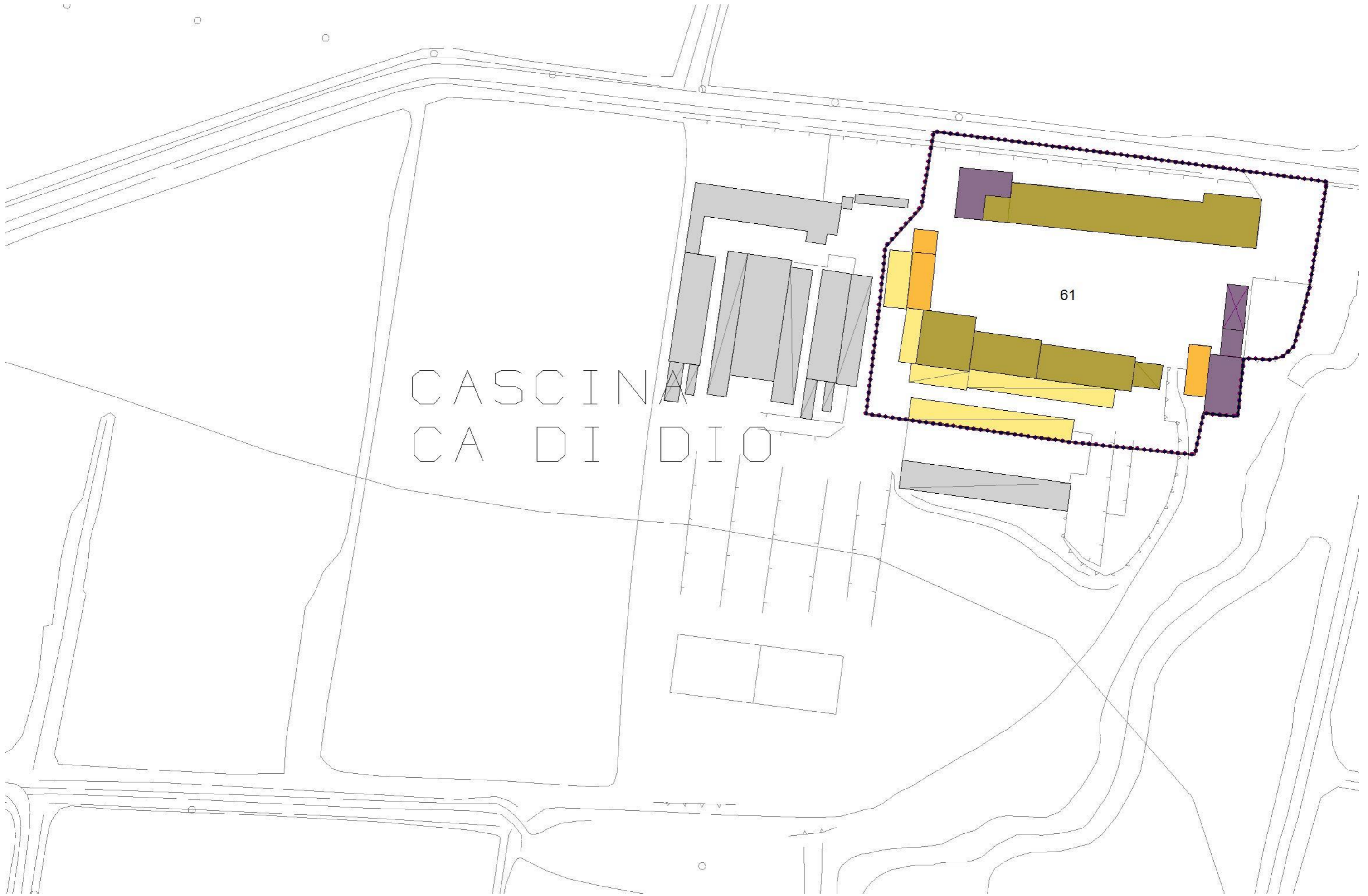

CASCINA
DI DIO

61

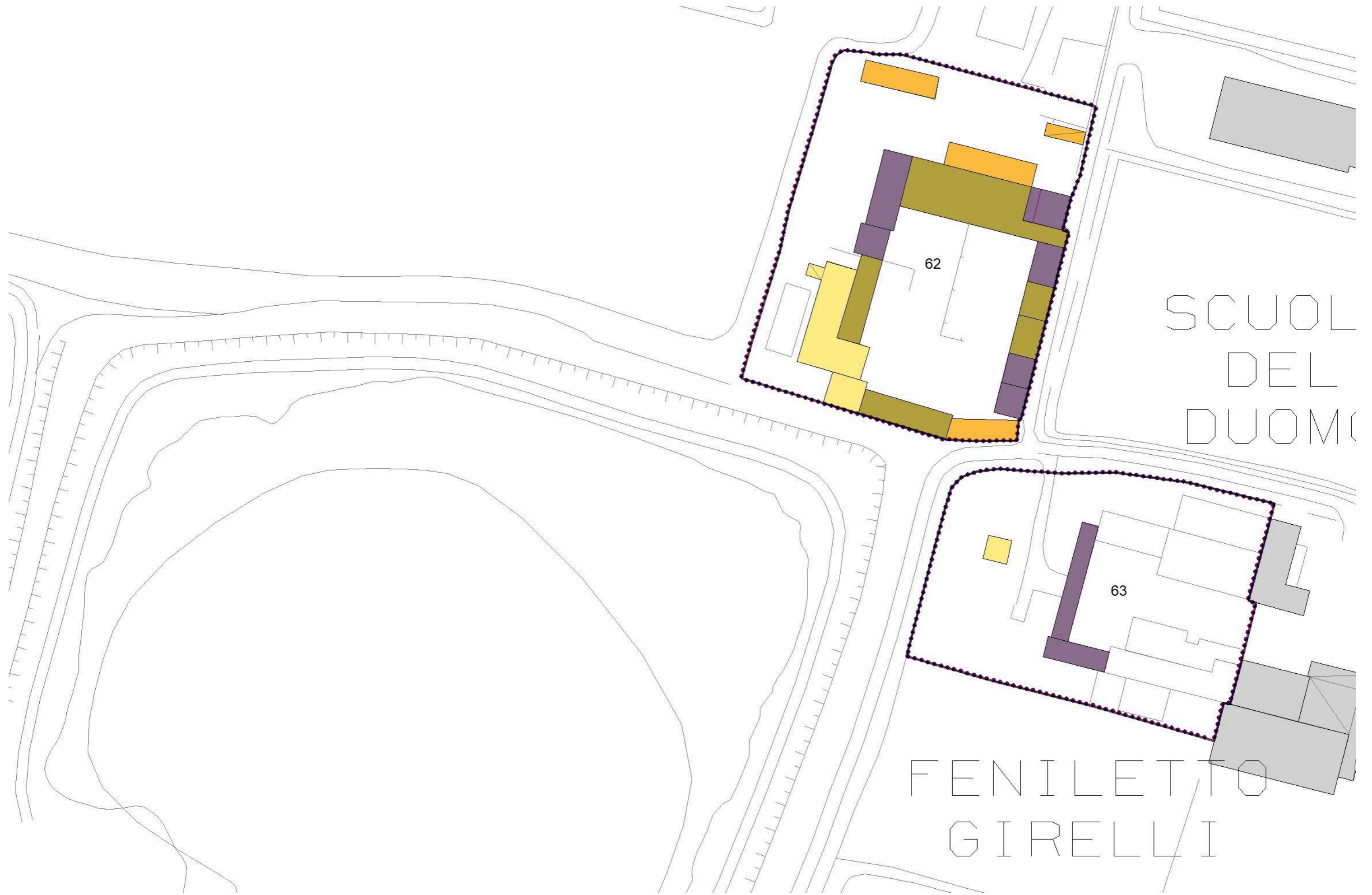

SCUOL
DEL
DUOMO

62

63

FENILETTO
GIRELLI

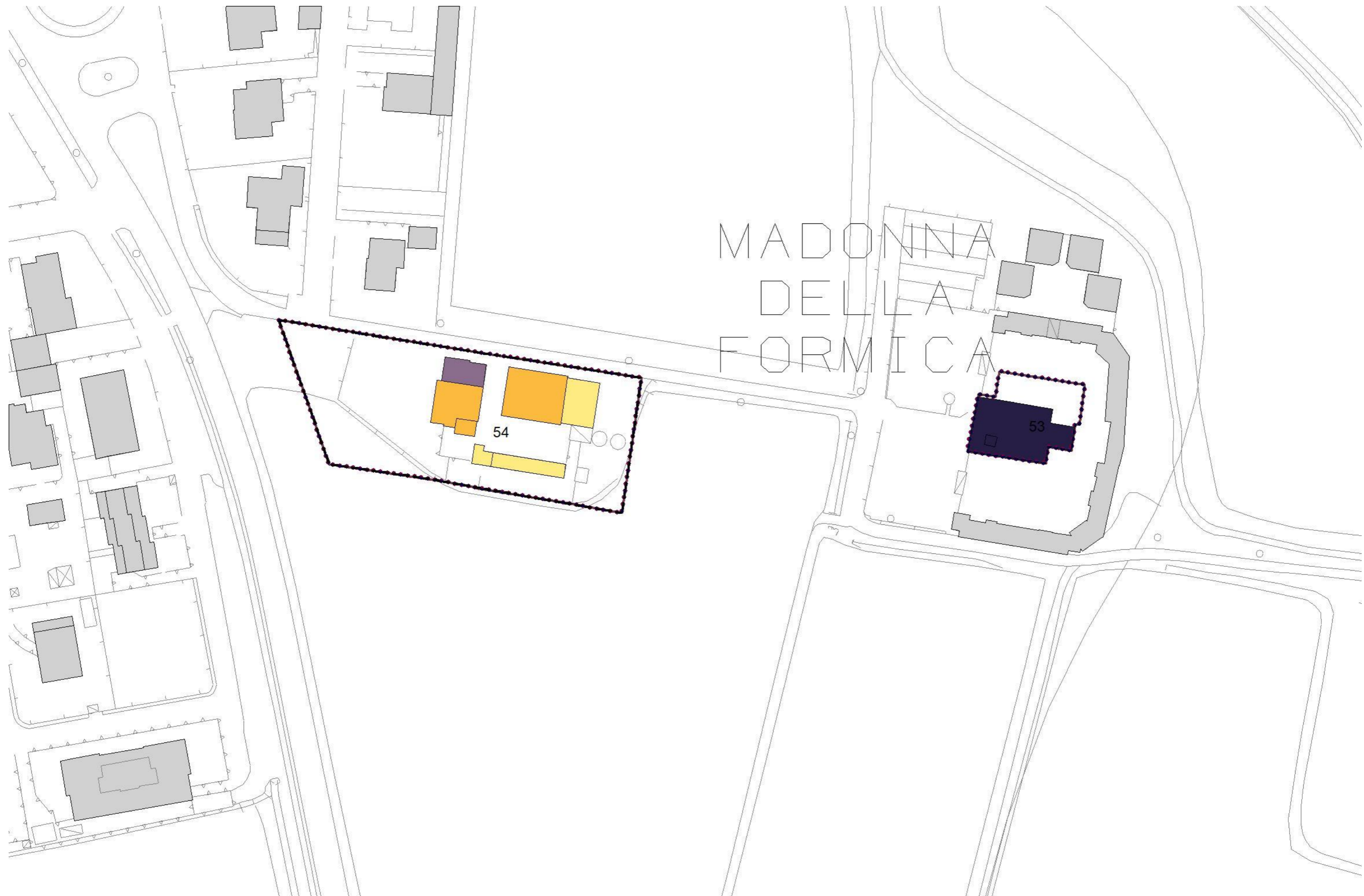

FENIL BASS

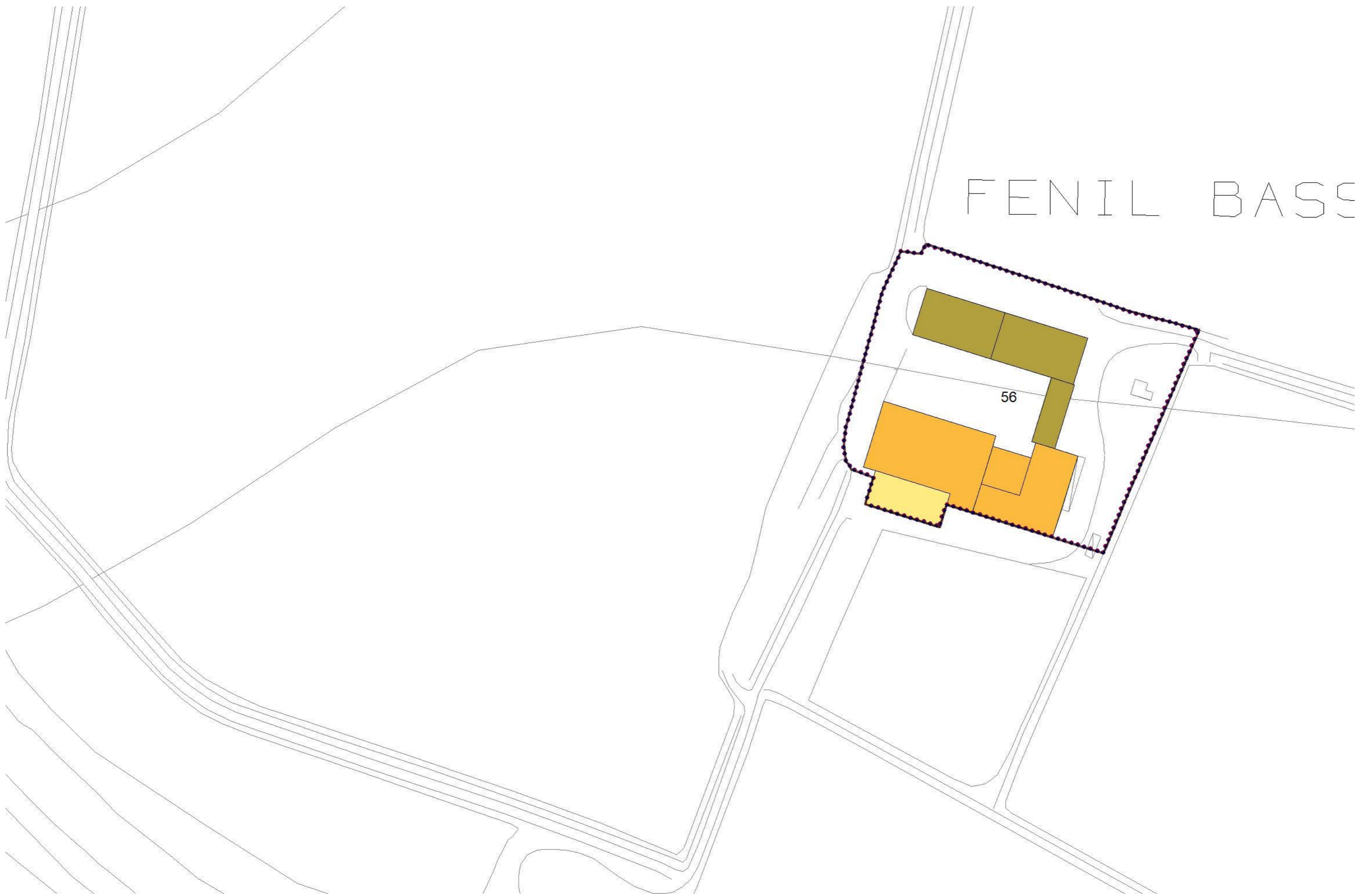

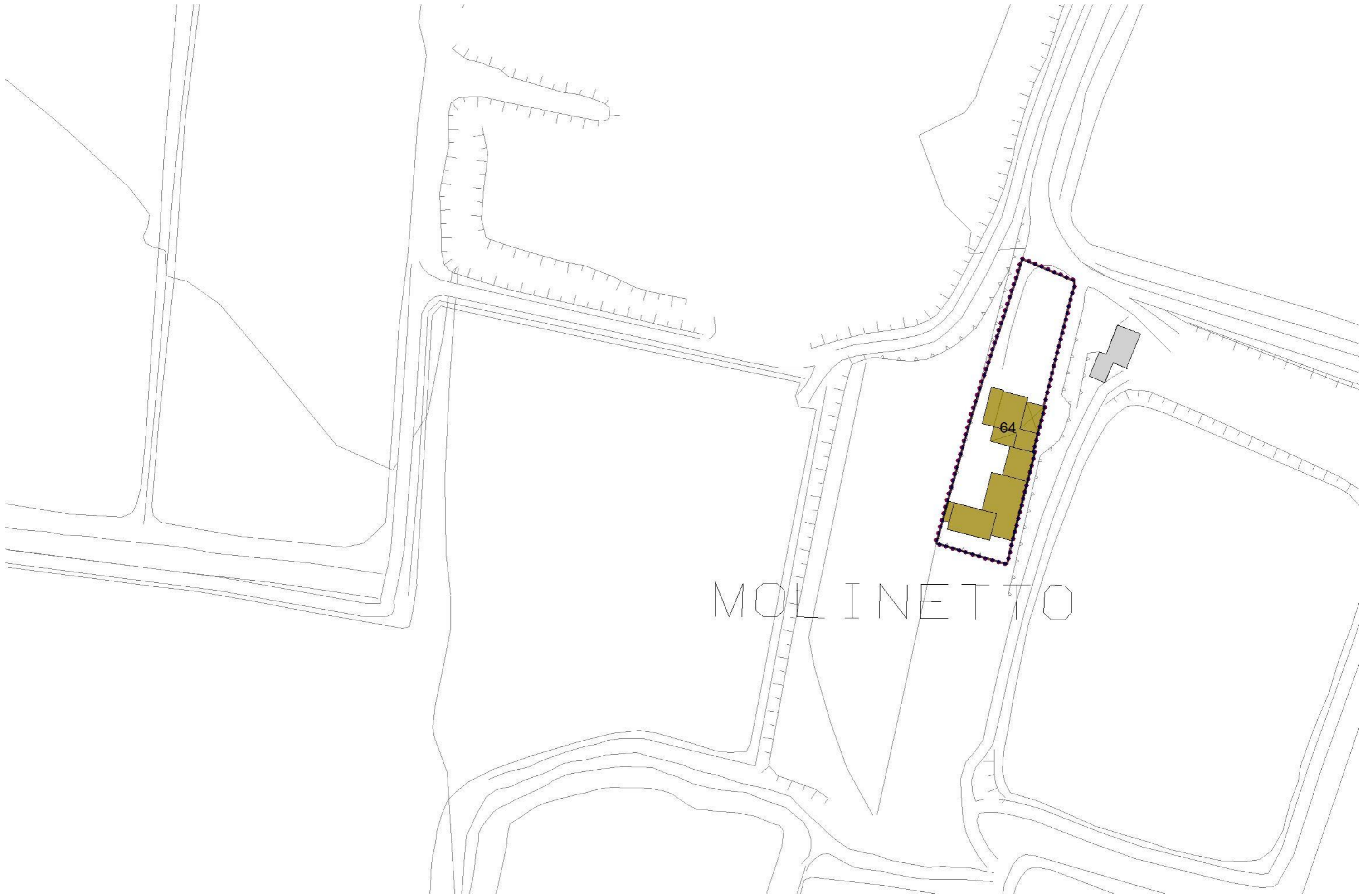

MOLINETTO

FENILETTO
ZAMARA



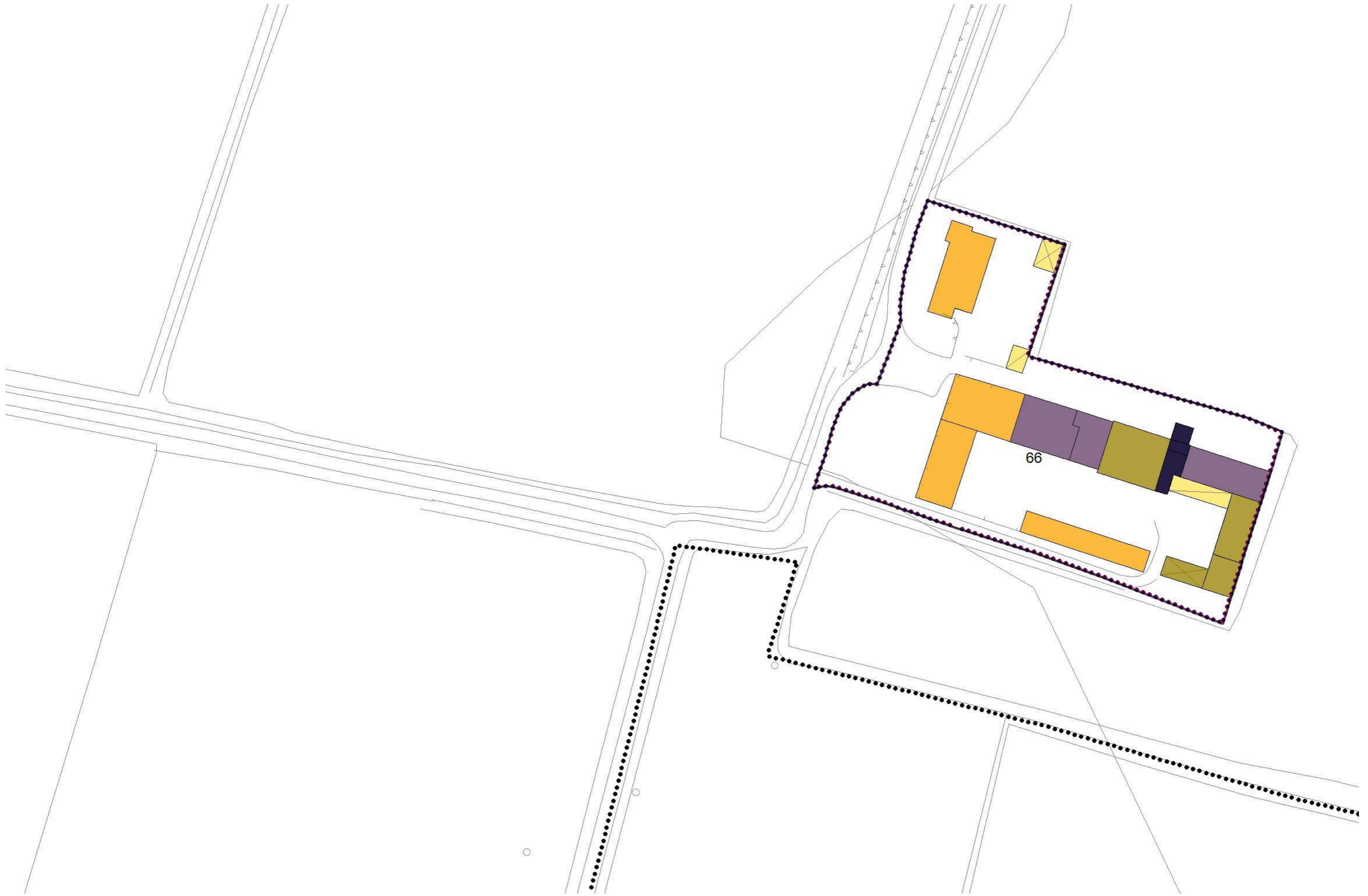





COOPERATIVA
MANERBIESE

CASCINA
CAMPAGNA

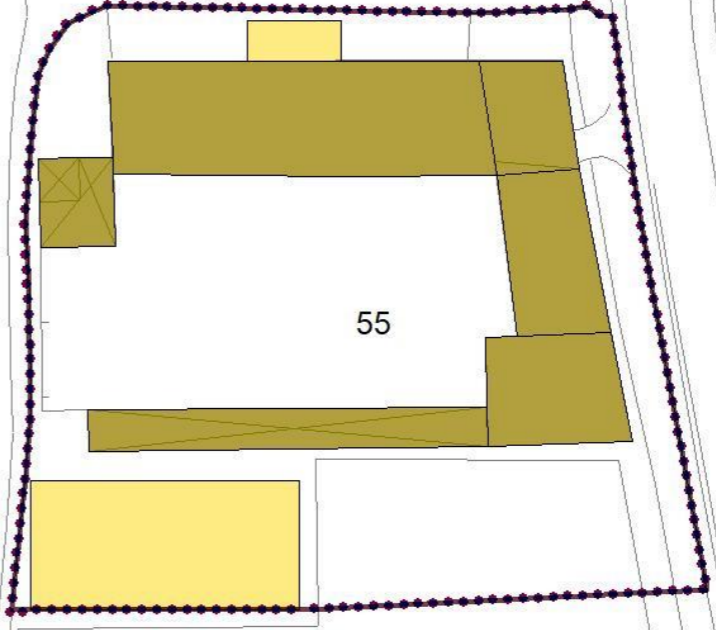

Caffurini

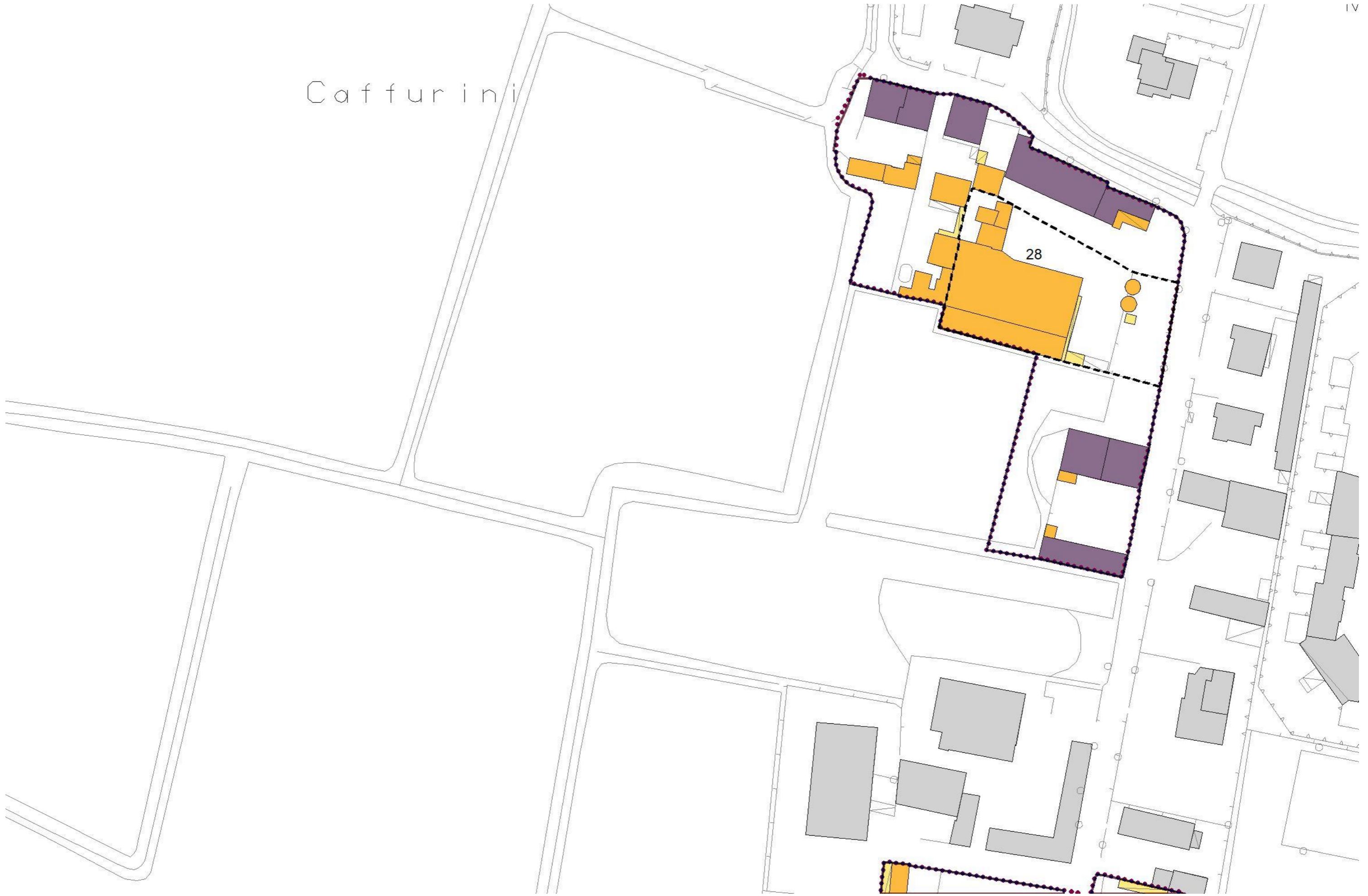



25

26

75

27

CASCINA

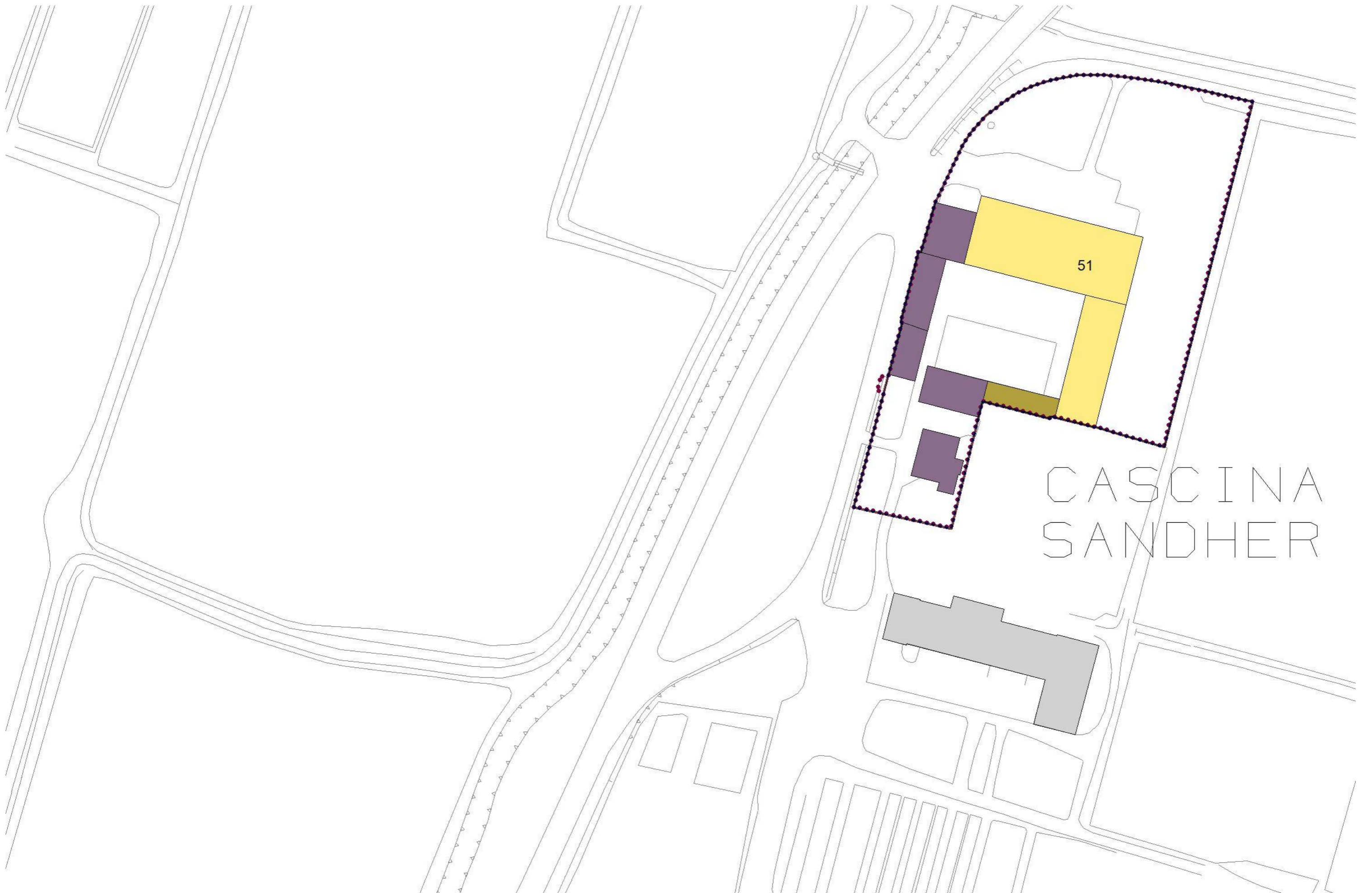

CASCINA
SANDHER

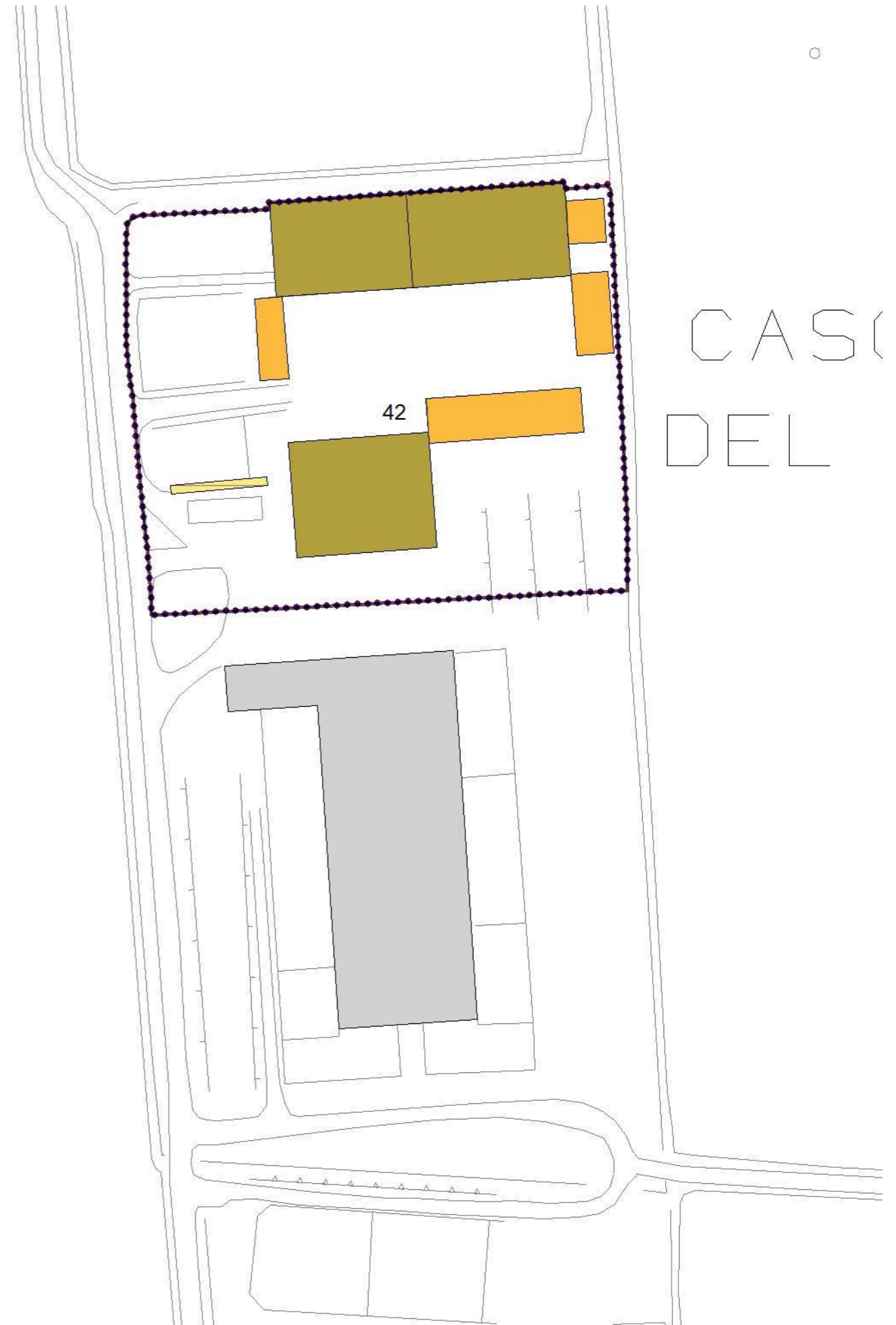
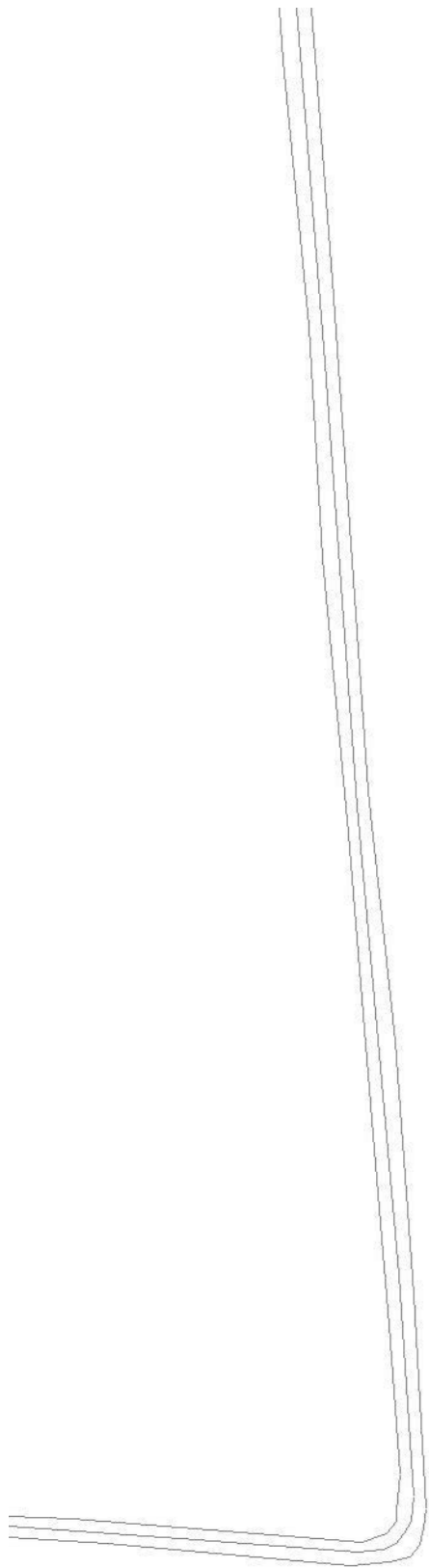

CASCINA
FENIL
GRANDE

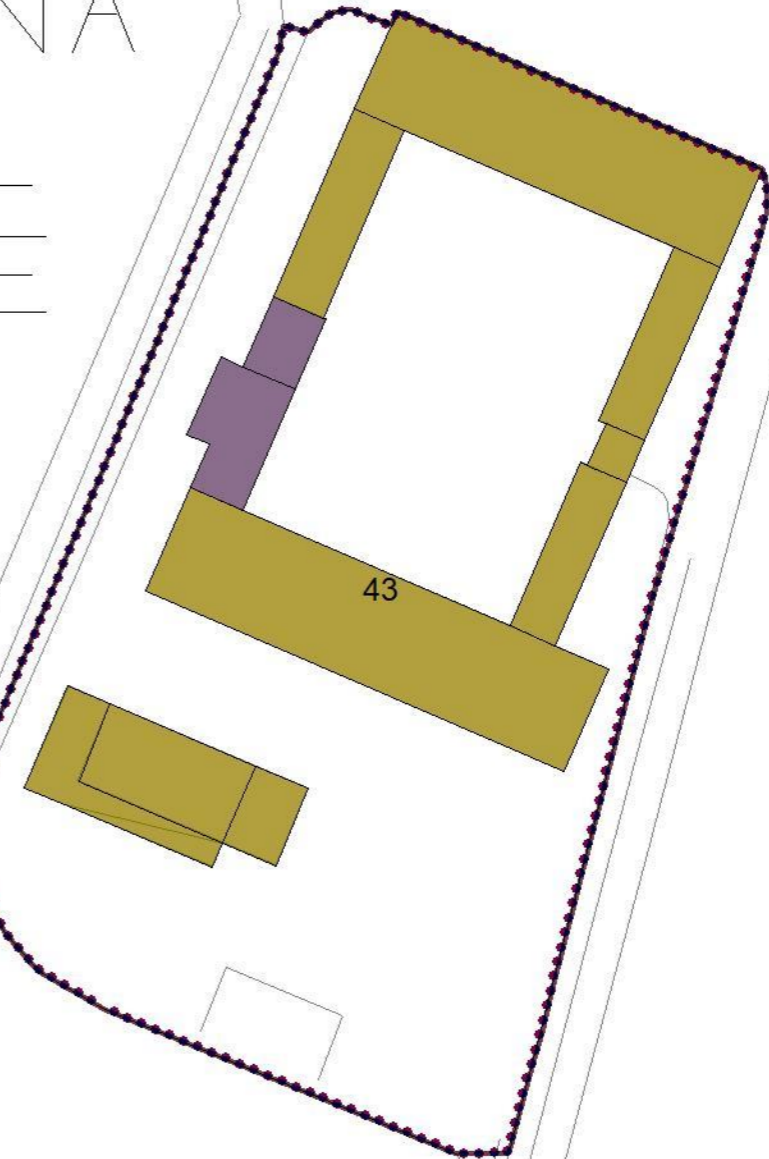

CASCINA
ROVATA



Rova

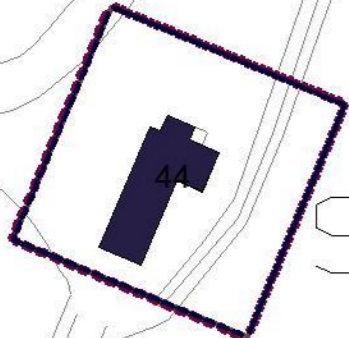

SANTUARIO MADONNA
DELLA SEGGIOLA

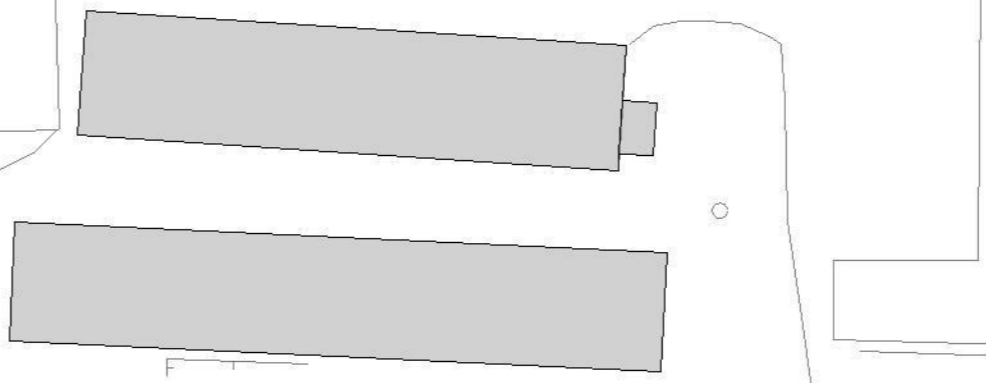

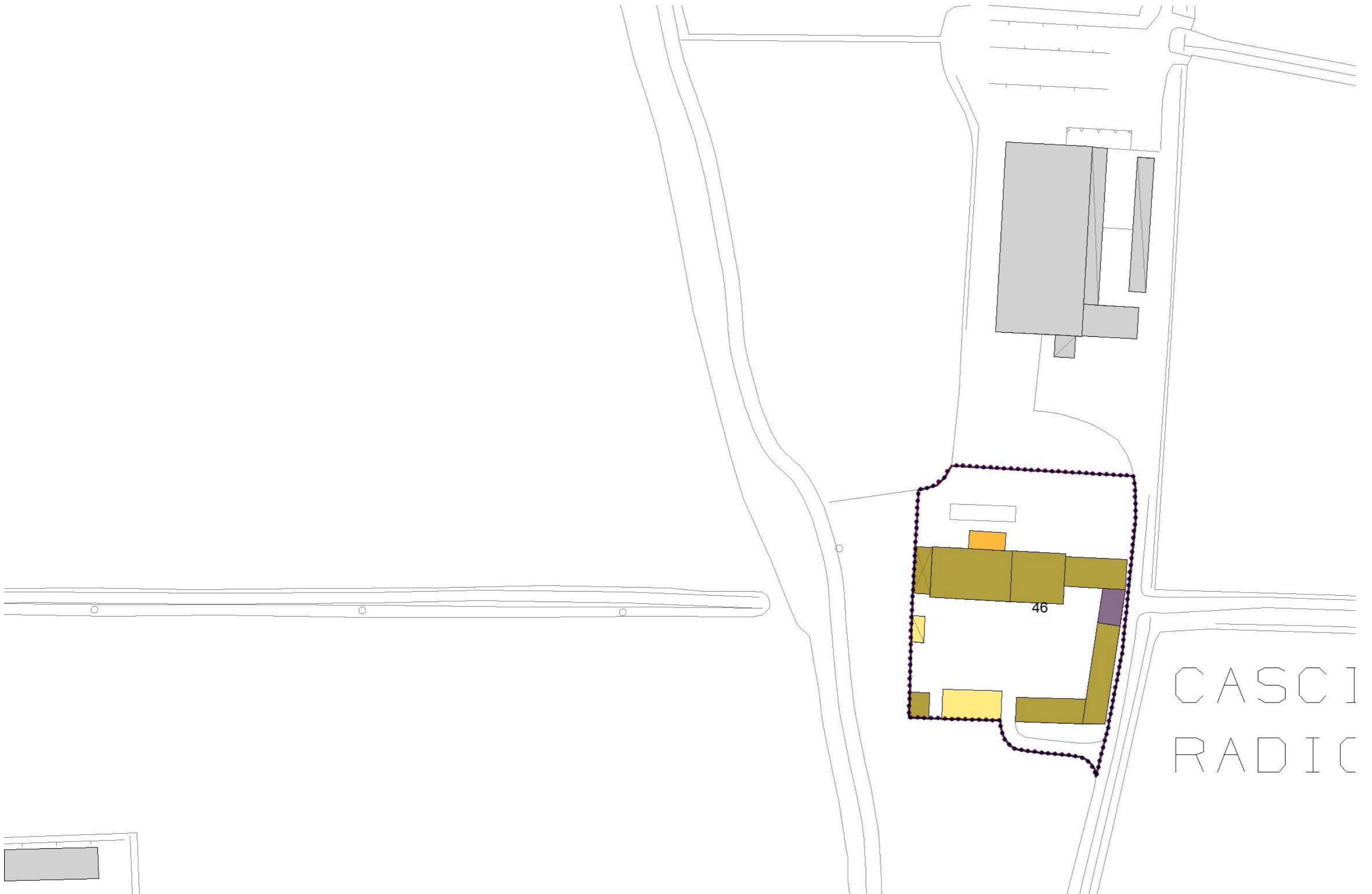

CASCI
RADIC

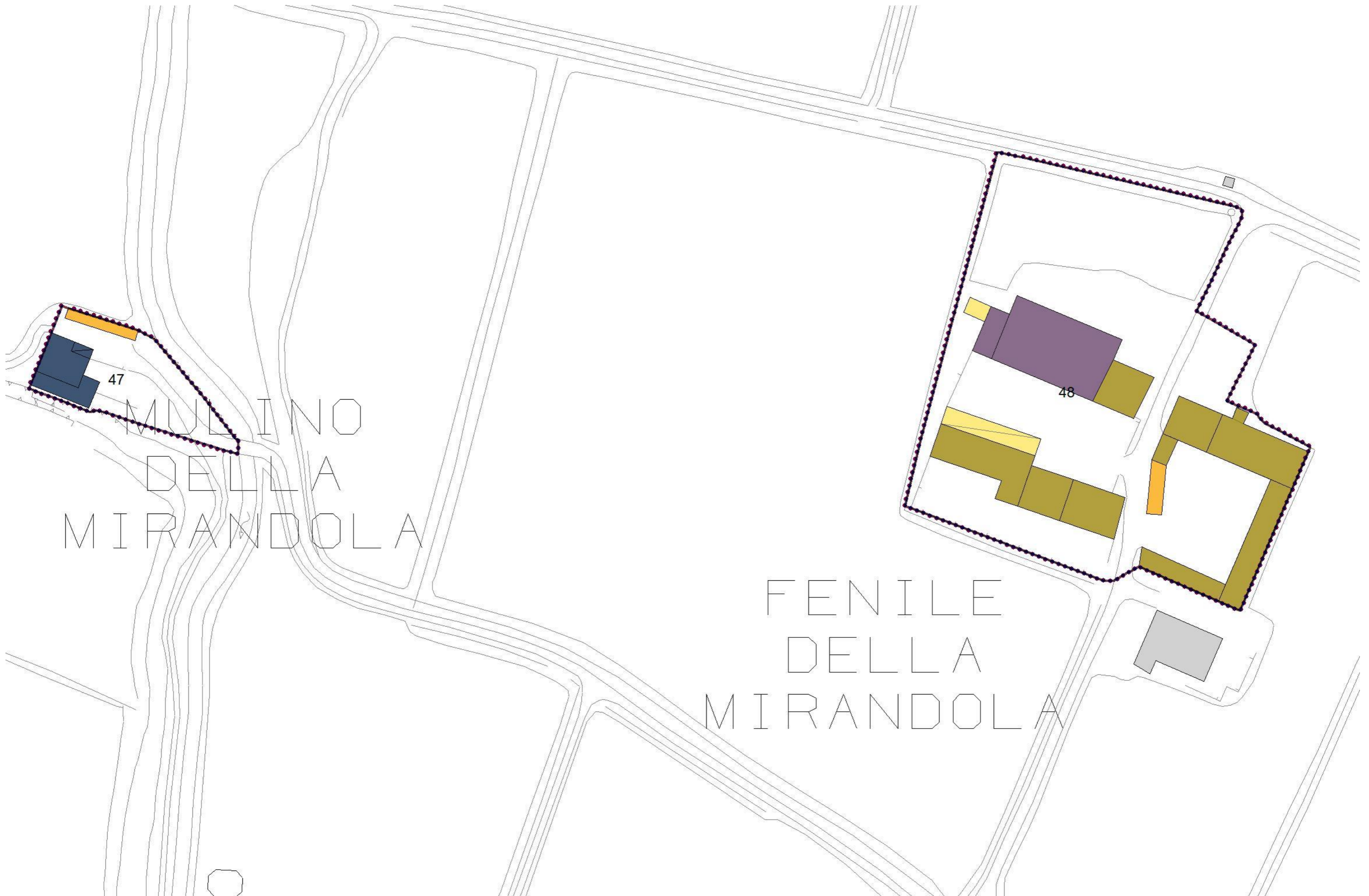

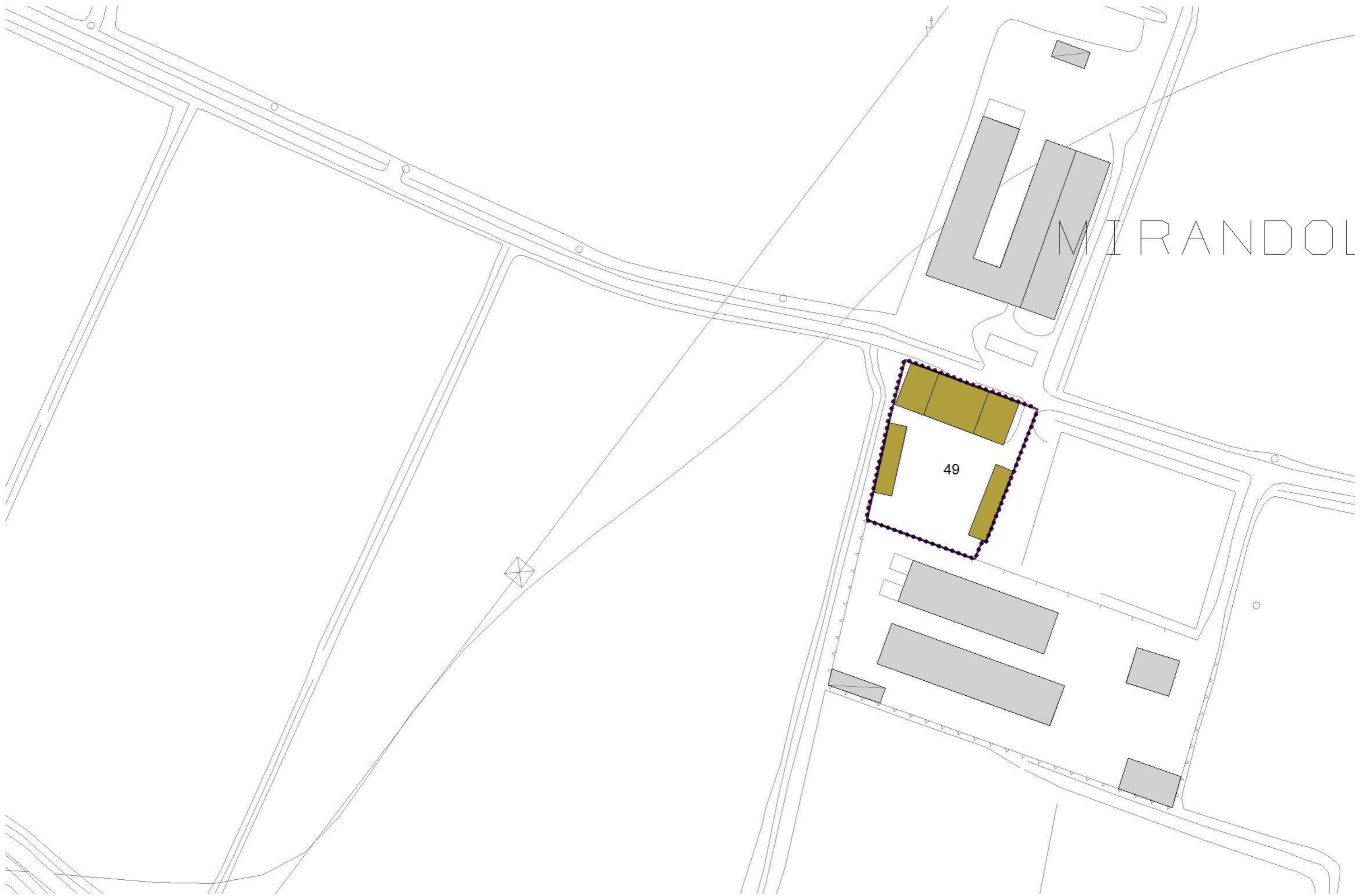

MIRANDOL

49

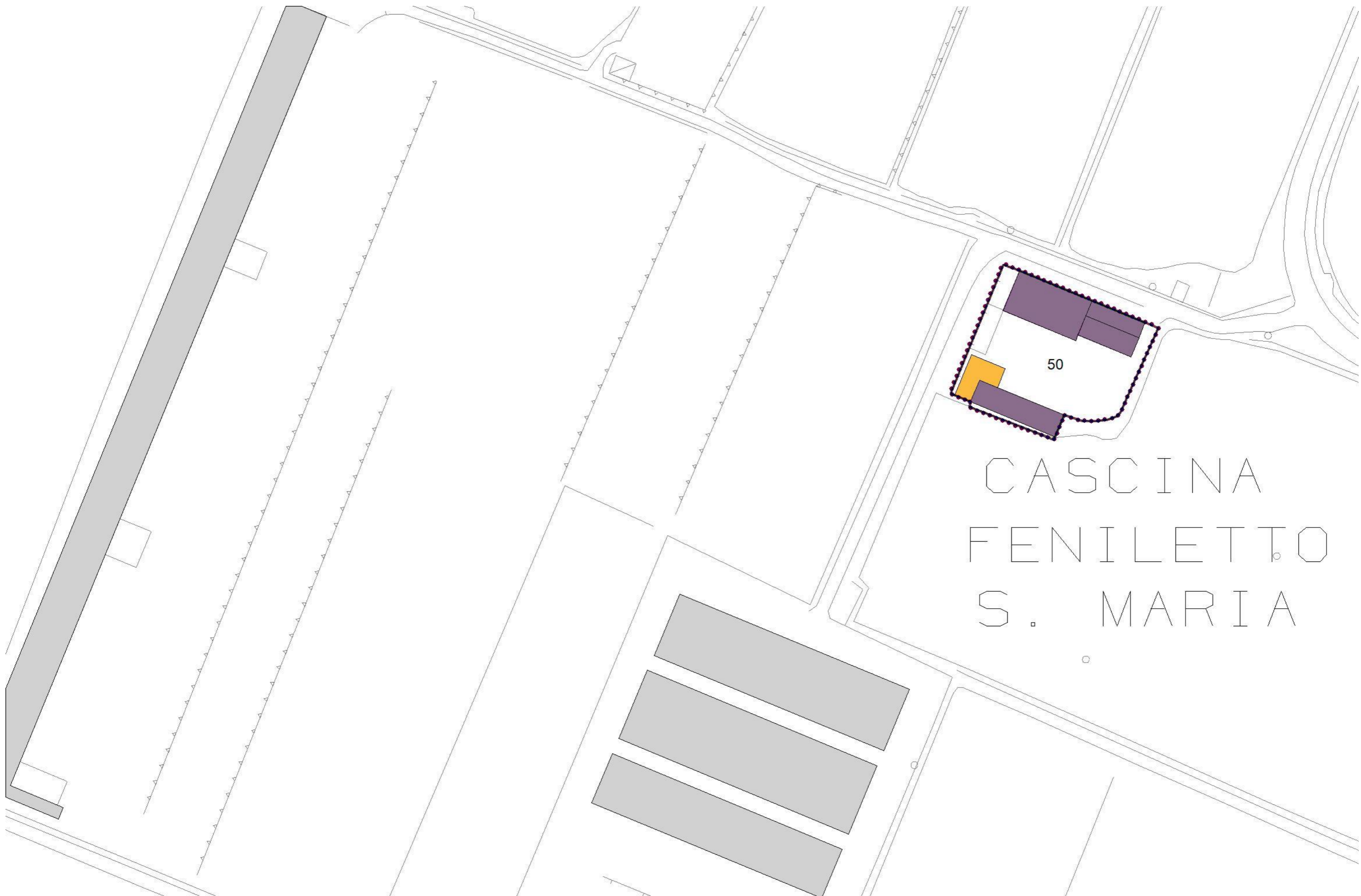

CASCINA
FENILETTO
S. MARIA

